



Smart Home Wireless Alarm System

User Manual



Product Introduction:

Thank you for choosing our product.

This product usage is for keeping house safe, good quality with convenient setup.

- ★ Based on the Tuya Smart home platform, work with most of the Tuya smart based products.
- ★ Support both Android and iOS Tuya APP, also support Smart Life APP.
- ★ High decibel audio, flashing lights and other alarm modes.
- ★ Disarm, Away, Home, SOS
- ★ System power ON/OFF detection
- ★ Usage for Home, Offices, Shops, Supermarket,etc.
- ★ Support Amazon Alexa, Google Assistant

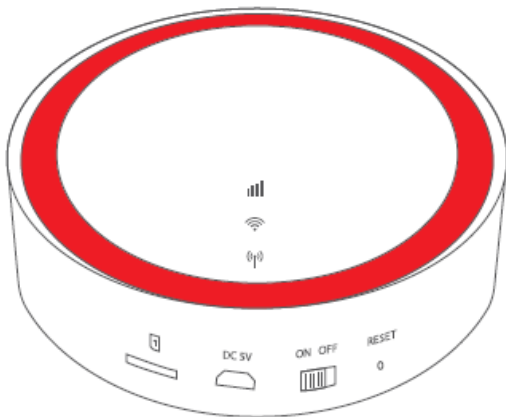

* Mark: GSM is optional

Download the APP and register

Search for "Tuya Smart" or "Smart Life" app on your mobile, or scan the QR code below to download the app and register with your mobile number or email ID.



Tuya APP



Smart Life APP

How to connect WiFi network

1. Default mode

Step1, Open the APP homepage, press "+" in the upper right corner to add devices

→ select "Security&sensor" → select "Alarm(WiFi)"

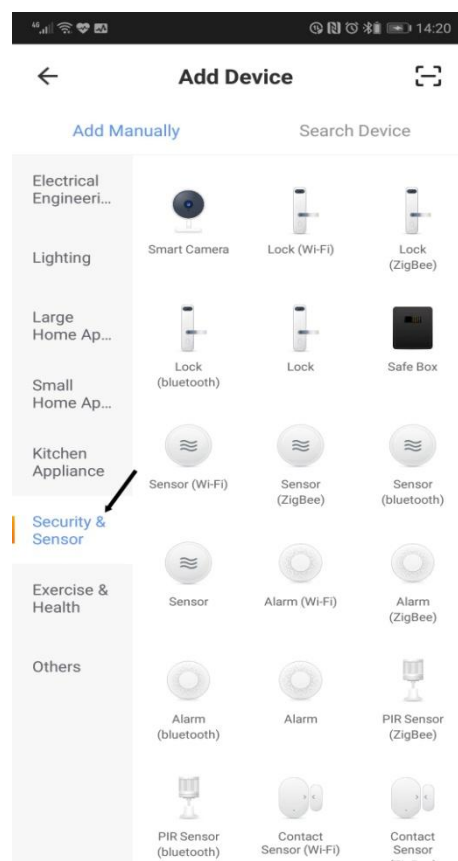
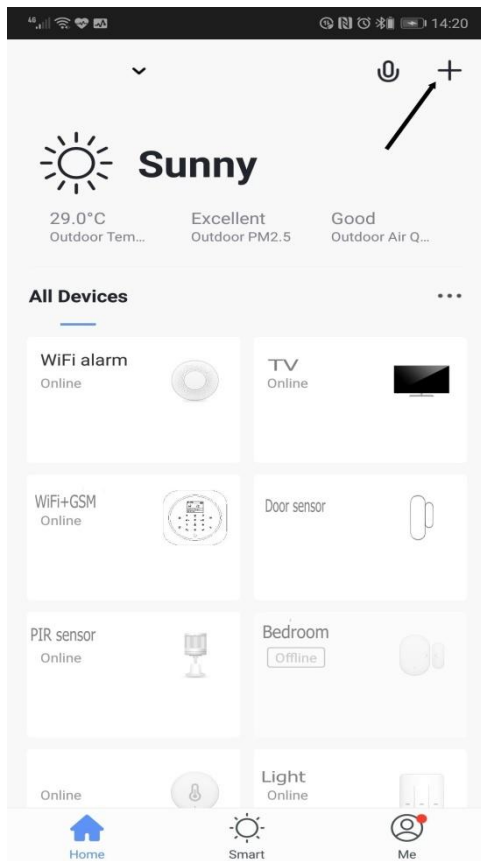

Step2, Reset the product (press RESET button for 1 second) till you hear "Di-Di" sound, and the middle LED flashing quickly → then Confirm indicator rapidly blink

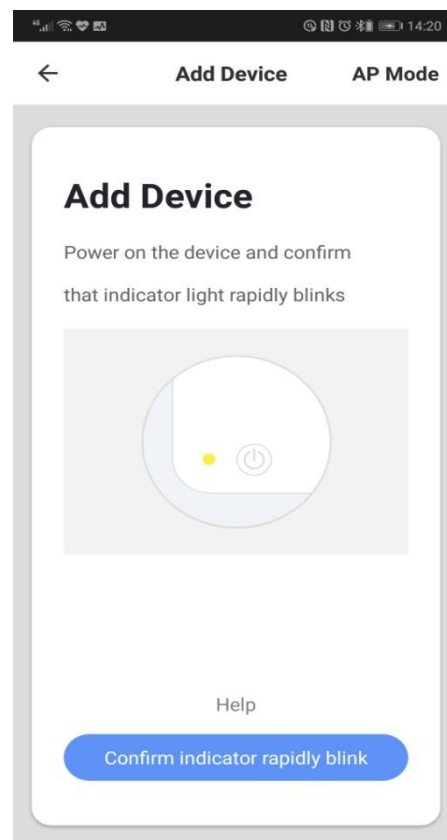
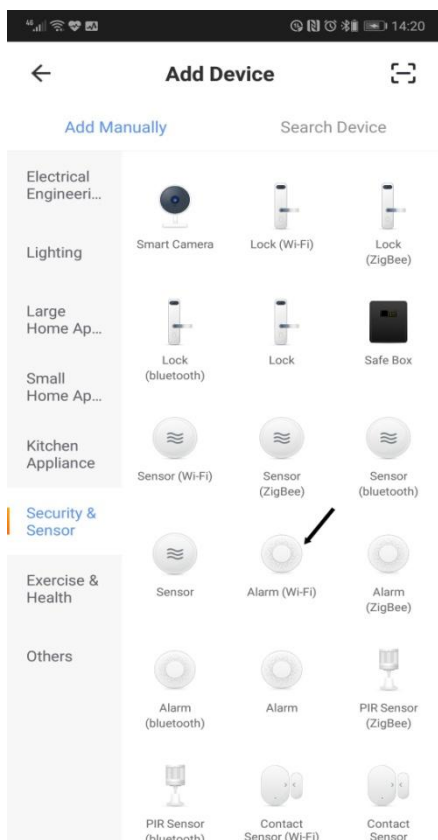

Step3,Enter WiFi password(2.4G WiFi only) → OK, connecting → Added successfully

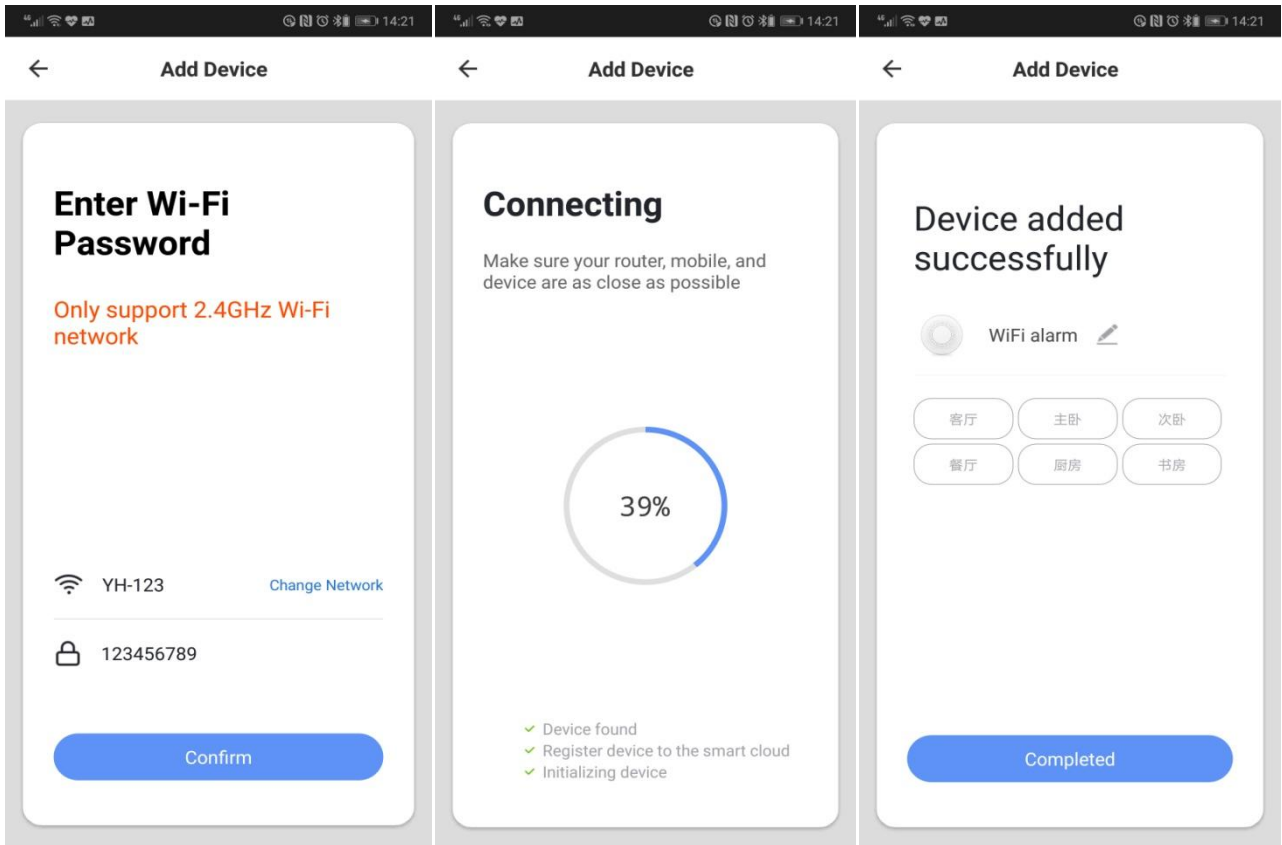

2. If the Normal mode to connect WiFi is unsuccessful, you can select AP(compatible) mode.
Step1, Open the APP homepage, press "+" in the upper right corner to add devices
→ select "Security&sensor" → select "Alarm(WiFi)"

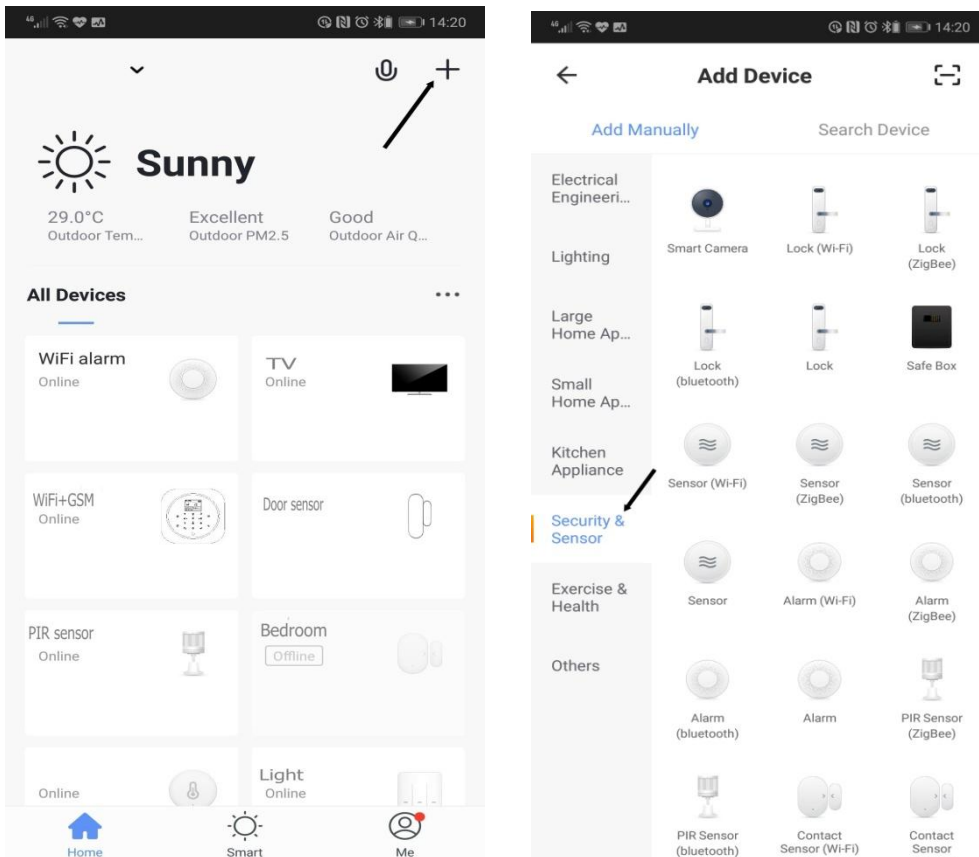

Step2, Reset the product (keep pressing the RESET on the product for 5 seconds) till you hear "Di" sound, and the LED flashing slowly → select "AP mode"

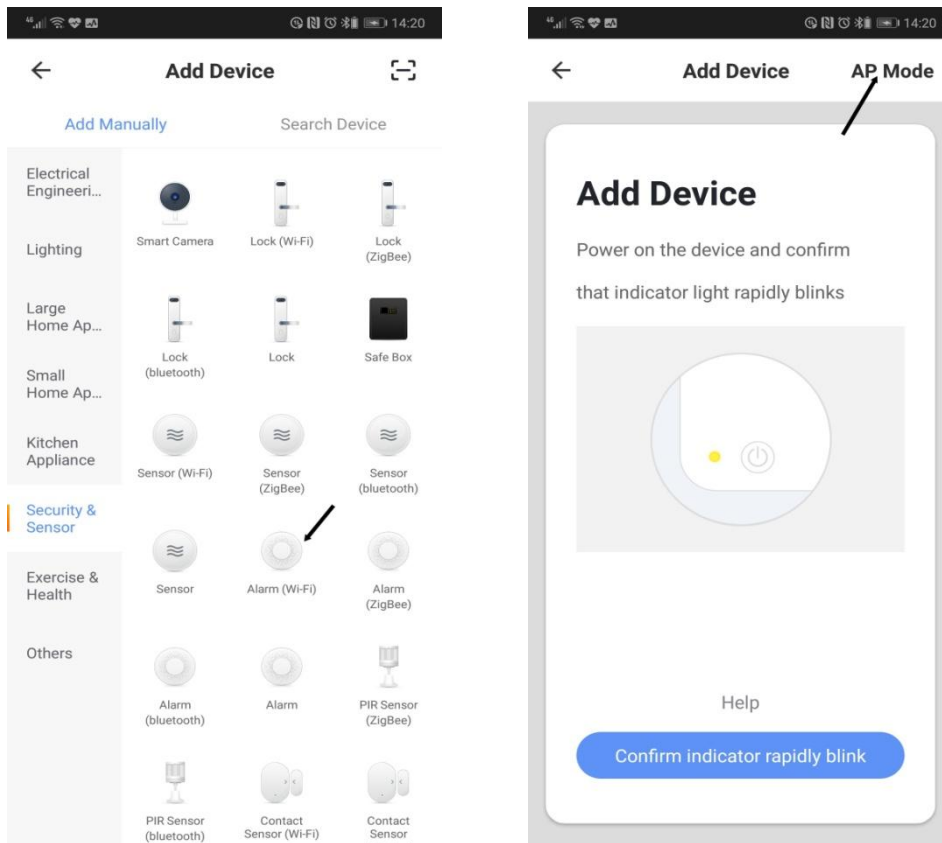

Step3, "Confirm indicator slowly blink" → "Go connect" → Find out "Smart Life-xxx" in wifi list

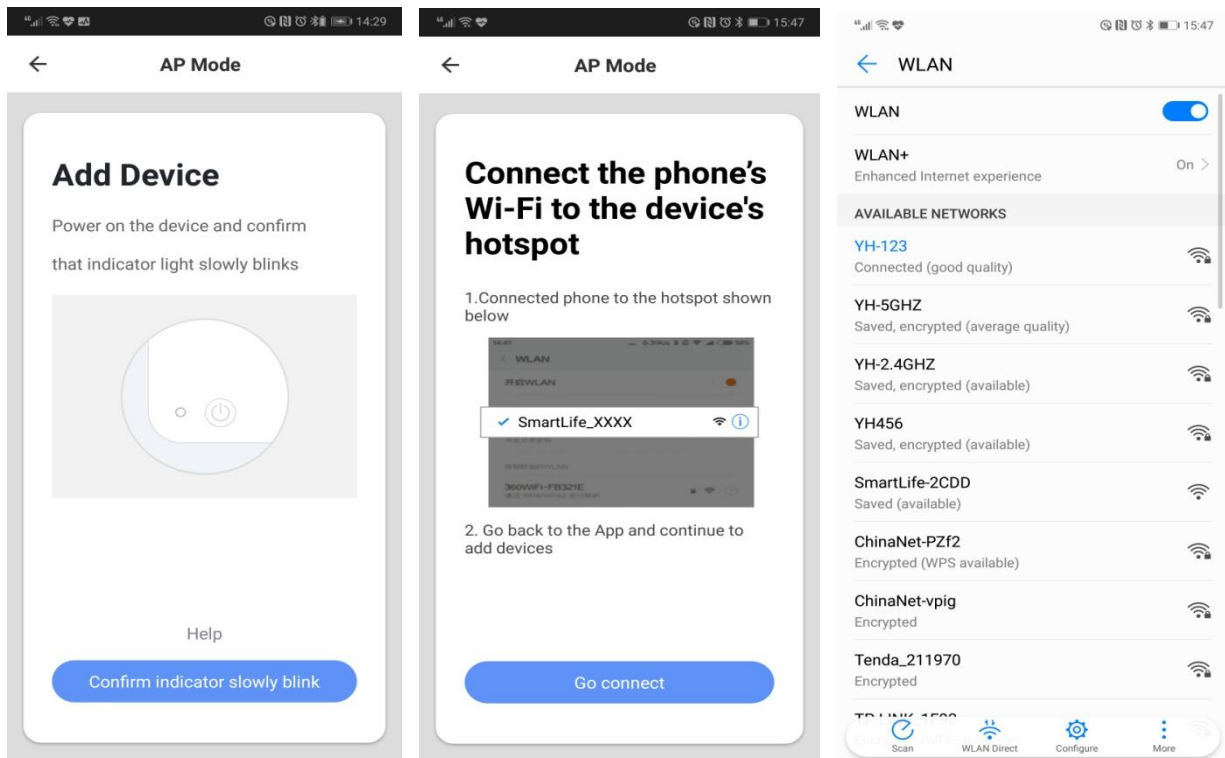

Step4, Connected Smart Life-xxx wifi → Connecting → Added successfully.

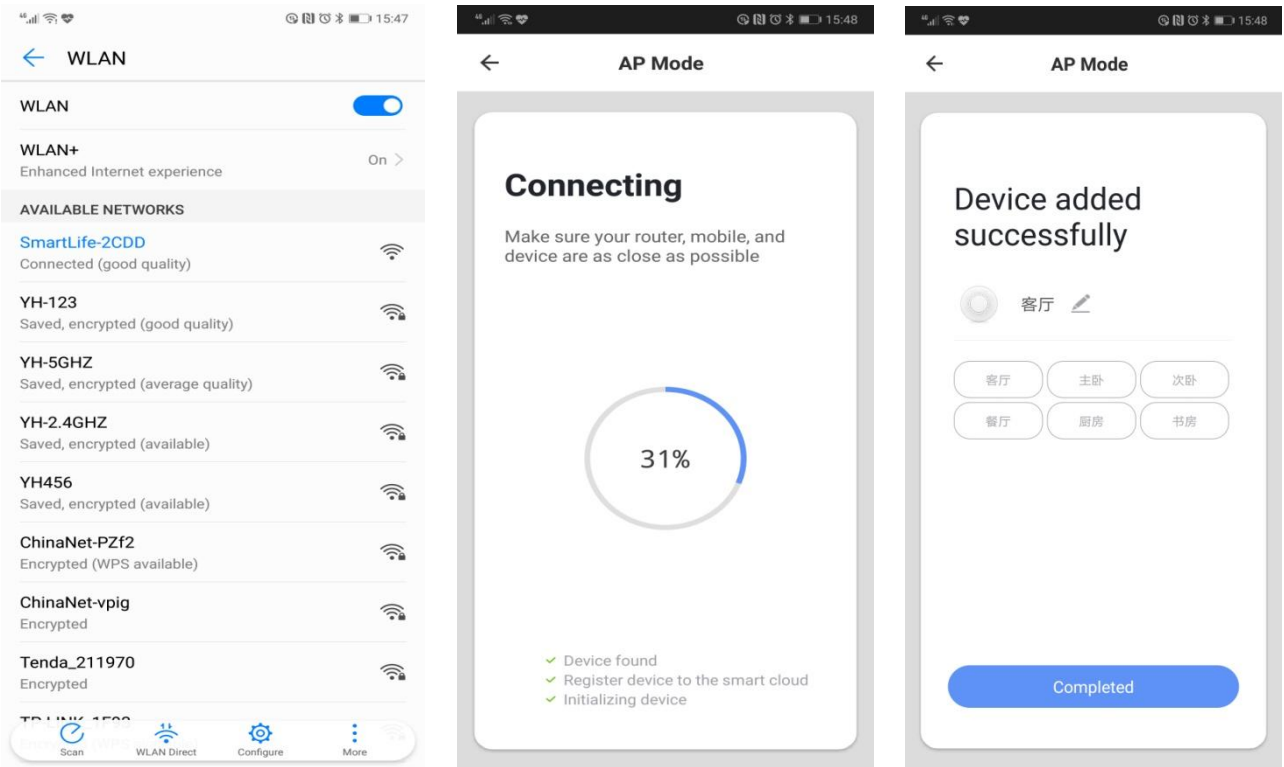

Add detectors and remotes via APP

Click on APP "accessories" → press "+" in the upper right corner to add wireless detector → trigger the detector and add successfully.

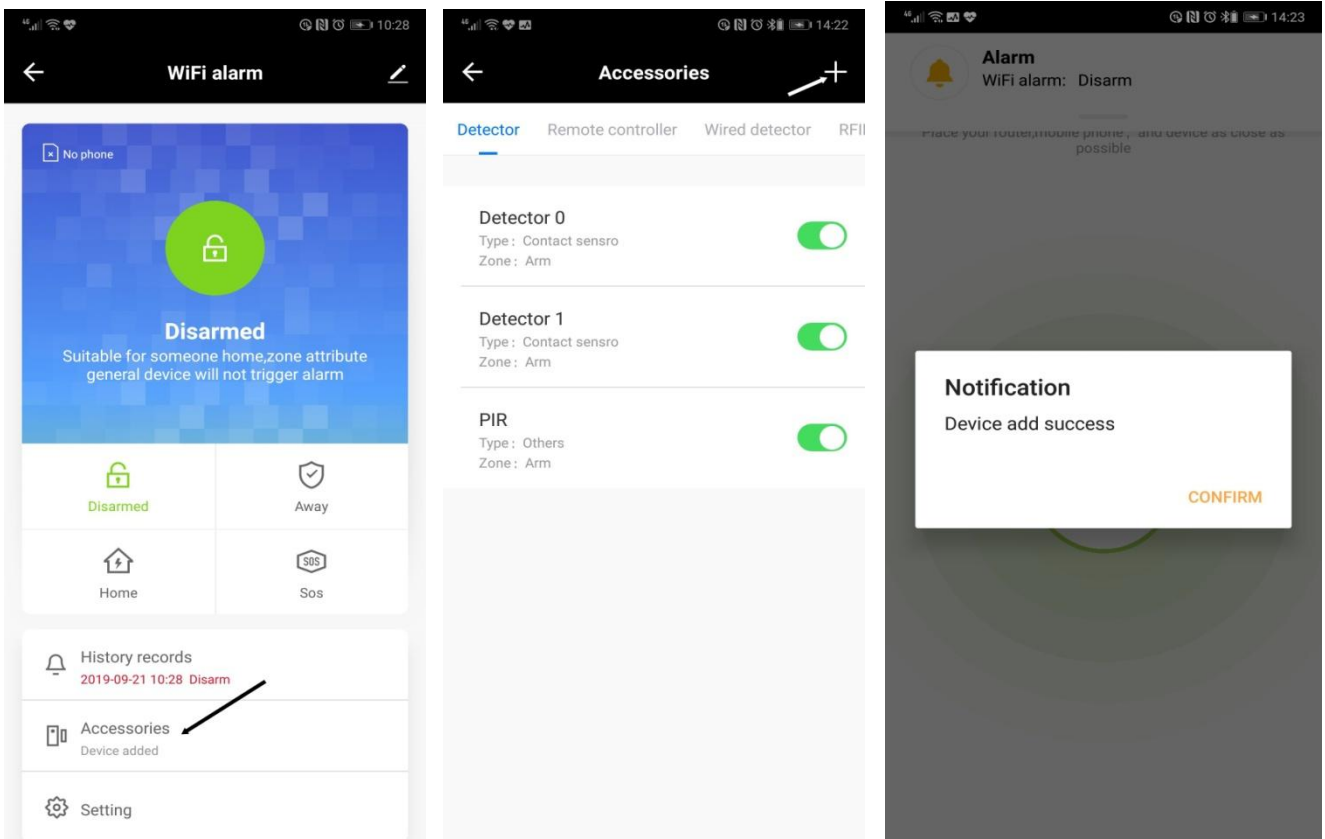

You can edit all the devices name in order to make it easier to distinguish different alarm events.

Device sharing enables multi-users and management functions

Step1, Come to the app homepage, click on "Me" → "Home Management"

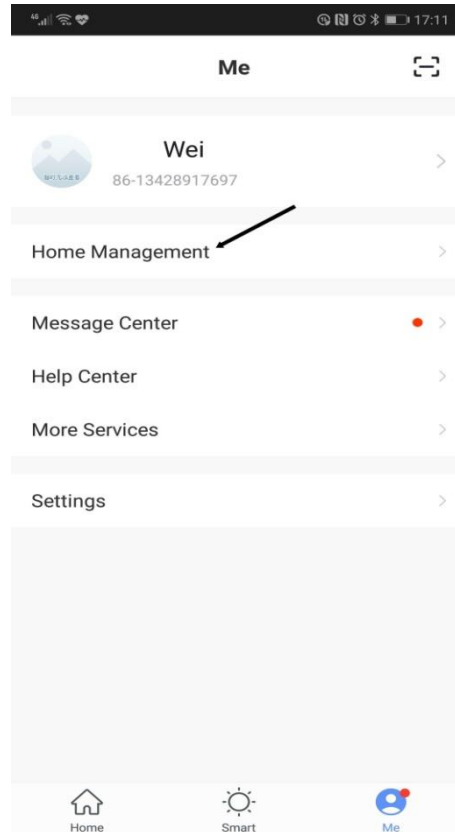
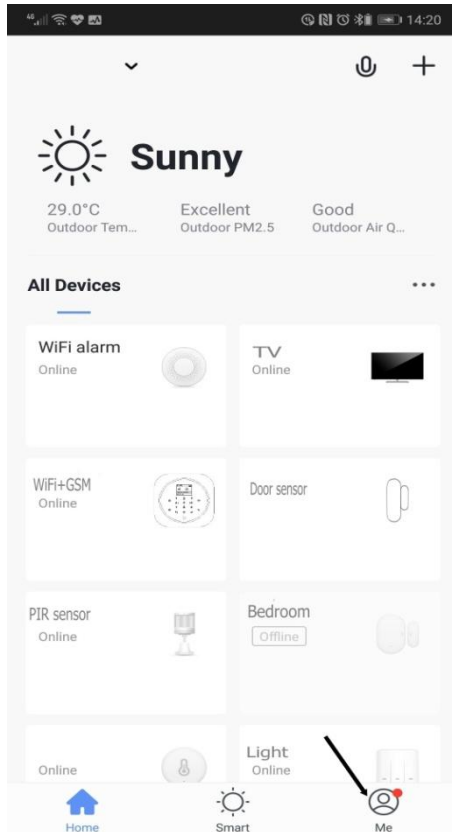

Step2, Select your name → "Add Member" →

Then enter the name & phone number of the relevant member, and you can set as an administrator.

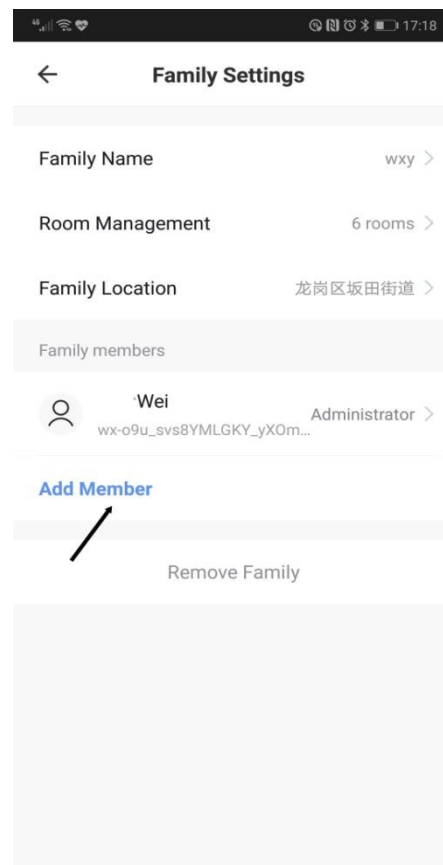
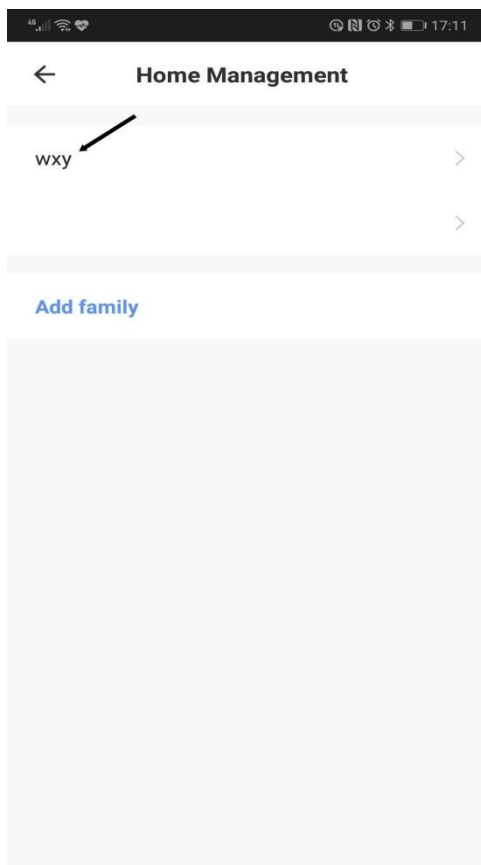

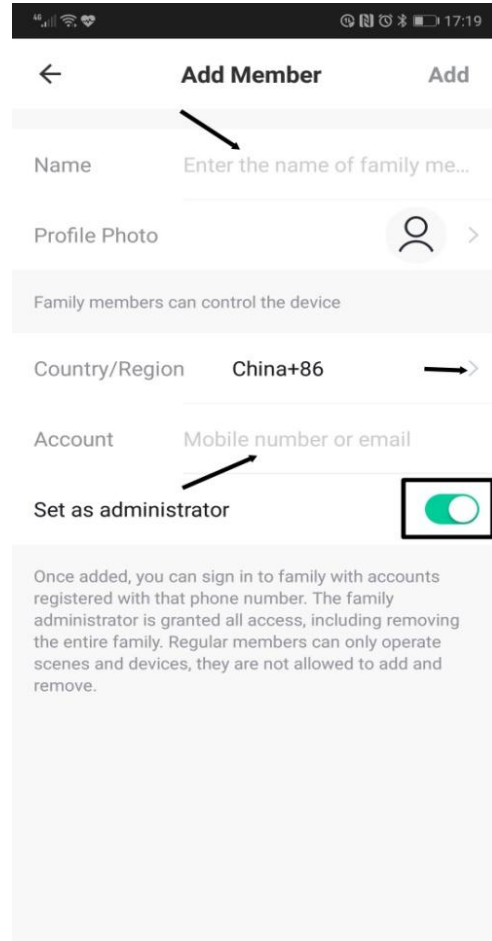
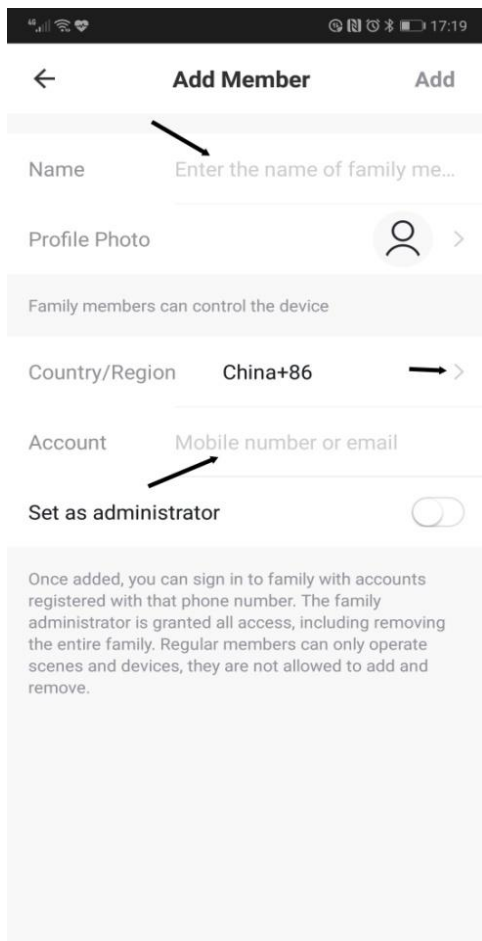

GSM card option

WiFi model without GSM; and GSM&WiFi model with GSM, able to put SIM card inside the panel, Then set up phone number to call and send SMS when alarm.

