

# G600M-BCE

## Monitored Mini Stainless Steel Magnet



- Rear Cable Entry
- Operating Voltage 12Vdc
- Stainless Steel
- Holding force up to 600lbs (272kg)
- Weather resistant: IP65
- Vandal resistant
- Monitored



WEATHER  
RESISTANT  
— IP65 —



VANDAL  
RESISTANT



STAINLESS  
STEEL

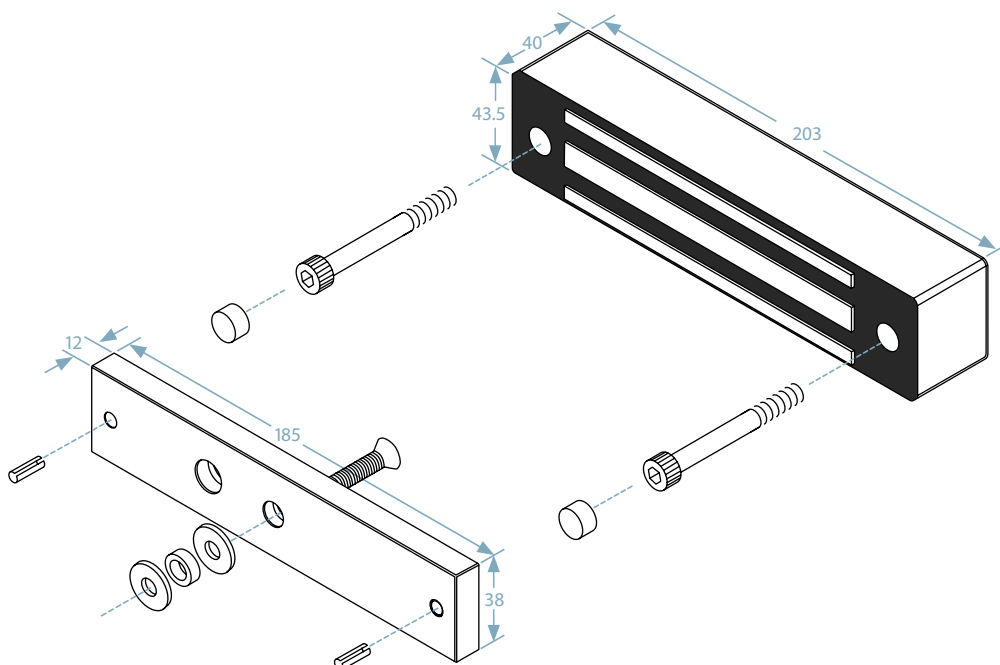

### WATERPROOF PROPERTIES

This series of waterproof magnetic locks are sealed with an epoxy potting compound (E87252 (S), UL94V-0) and is protected by this compound. They are proved to withstand a water resistance as established in test procedures of IP 65.

